



输出功率：约0.1~1.5W  
塑胶行星减速电机

OUTPUT:APPROX0.1~1.5W  
Plastic Planetary Gear Motor

典型应用： 电子门锁  
智能家居  
智能机器人  
电动玩具

Typical Applications: Electronic Door Lock  
Smart Home Appliance  
Smart Robot  
Electric Toys

## 1.OUTLINE DRAWING:

UNIT:MM

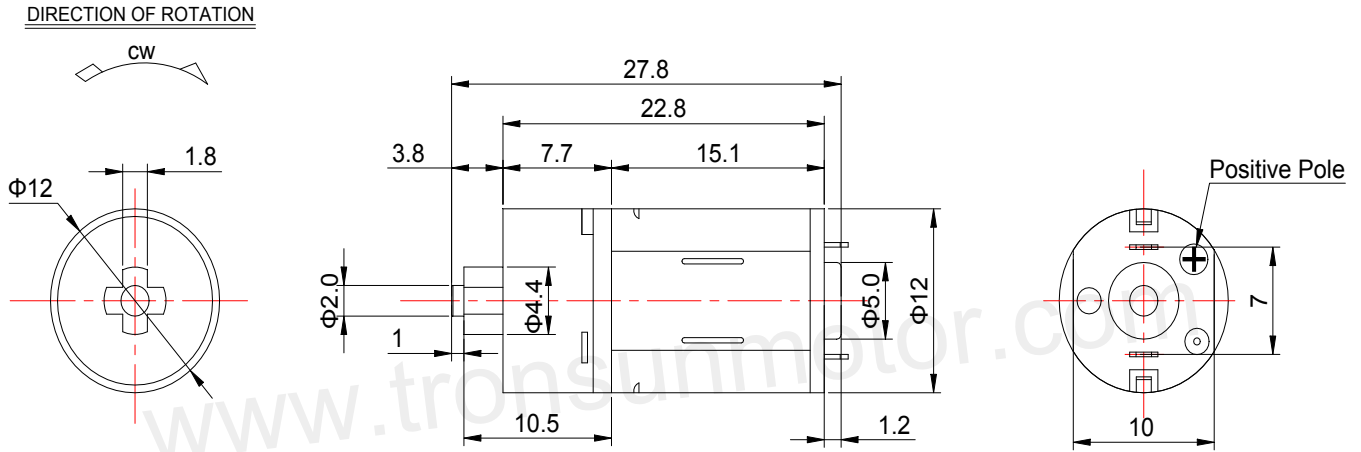

Customizable Parameters:  
1. Electric Performance

WEIGHT: 6.7g(Approx)

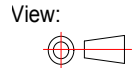

## 2.GEARBOX REDUCTION RATIO:

Gearbox Length (mm)	Stage Number	Reduction Ratio				Rated Torque	Bearable Maximum Instant Torque
						g.cm	
7.7	1	120/1			400	800	

## 3.MOTOR PERFORMANCE :

1mN.m $\approx$ 10.2g.cm $\approx$ 0.142oz.in

MODEL	REDUCTION RATIO	VOLTAGE		NO LOAD		AT MAXIMUM EFFICIENCY				STALL	
		OPERATING RANGE	NOMINAL	SPEED	CURRENT	SPEED	CURRENT	TORQUE	OUTPUT	TORQUE	CURRENT
			V	rpm	A	rpm	A	g.cm	W	g.cm	A
12PAN20-120-03200	120/1	1.5~3.5	3.0	200	0.11	166	0.4	300	0.51	2080	2.15
12PAN20-120-03125	120/1	1.5~3.5	3.0	125	0.072	101	0.24	300	0.31	1560	0.98
12PAN20-120-04.8150	120/1	2.0~5.0	4.8	150	0.05	124	0.18	300	0.38	1780	0.81
12PAN20-120-04.5130	120/1	2.0~5.0	4.5	130	0.043	103	0.15	260	0.27	1276	0.59
12PAN20-120-06175	120/1	2.5~6.0	6.0	175	0.05	145	0.18	300	0.45	1790	0.8
12PAN20-120-06230	120/1	2.5~6.0	6.0	230	0.085	194	0.31	400	0.80	2610	1.6
12PAN20-120-09200	120/1	3.0~9.0	9.0	200	0.04	150	0.2	500	0.77	2058	0.71